



**higher education
& training**

Department:
Higher Education and Training
REPUBLIC OF SOUTH AFRICA

MARKING GUIDELINE

NATIONAL CERTIFICATE

BUILDING DRAWING N2

25 JULY 2019

This marking guideline consists of 16 pages.

QUESTION 1: BRICKWORK

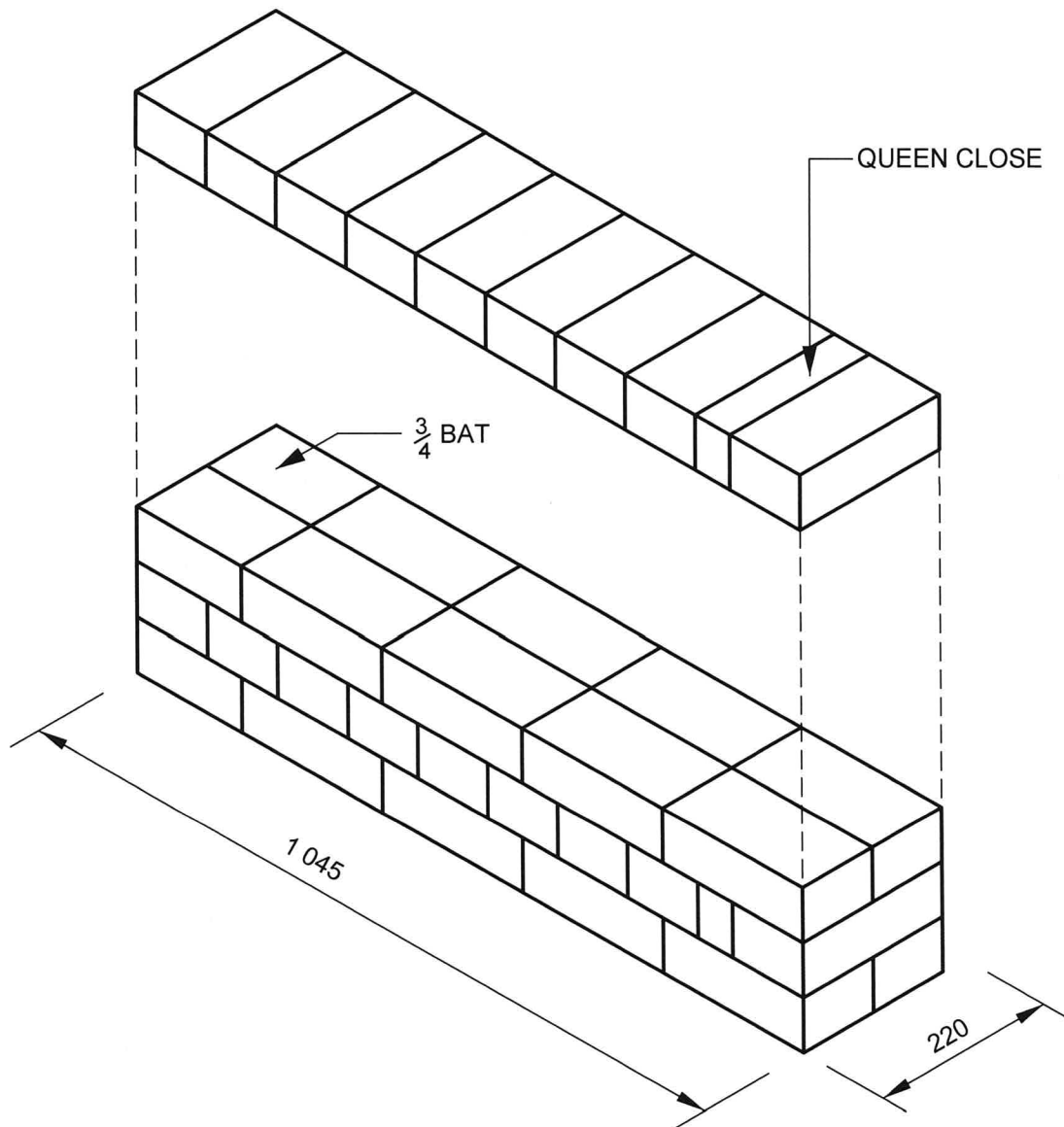

**ISOMETRIC VIEW OF A ONE-BRICK WALL BUILT IN ENGLISH BOND
SCALE 1:10**

RUBRIC FOR DRAWING QUESTION 1: BRICKWORK			
PART OF THE DRAWING	MARKING CRITERIA	POSSIBLE MARK	REMARKS
Isometric view	Axis	3	Alignment of the three projected corner
	Alignment	3	
Projected course	Correct length	3	
	Brick pattern	2	
	Brick size	1	220 x110 x 75 mm
	Stopped ends	2	
Three-courses wall	Correct length	3	
	Brick pattern	2	
	Brick size	1	220 x110 x 75 mm
	Stopped ends	2	
Other	Labelling	2	$\frac{3}{4}$ Bat & Queen closer
	Dimensions	2	1045 mm & 220 mm
	Subtotal	26	
	Divide by	3,25	
	Overall correctness	8	
	Line work	3	
	Accuracy	3	
Balanced layout and neatness		1	
	TOTAL	15	

NOTE: NO marks should be allocated for any part of the drawing in the incorrect position but marks should be allocated for hatching of that component.
Please note a mirror image of the original memorandum is acceptable and award marks as per mark allocation.
For Brick size - if the bricks sizes are drawn incorrectly, do not award the 1 mark.

SUMMARY QUESTION 1

Marking criteria	Possible mark	Marker	Internal moderator	External moderator
Correct axis	3			
Alignment	3			
Correct length	6			
Brick pattern	4			
Brick size	2			
Stopped ends	4			
Labels	2			
Dimensions	2			
Subtotal	26			
Divide by	3,25			
Overall correctness	8			
Line work	3			
Accuracy	3			
Balanced layout and neatness	1			
TOTAL	15			

QUESTION 2: FOUNDATION AND FLOORS

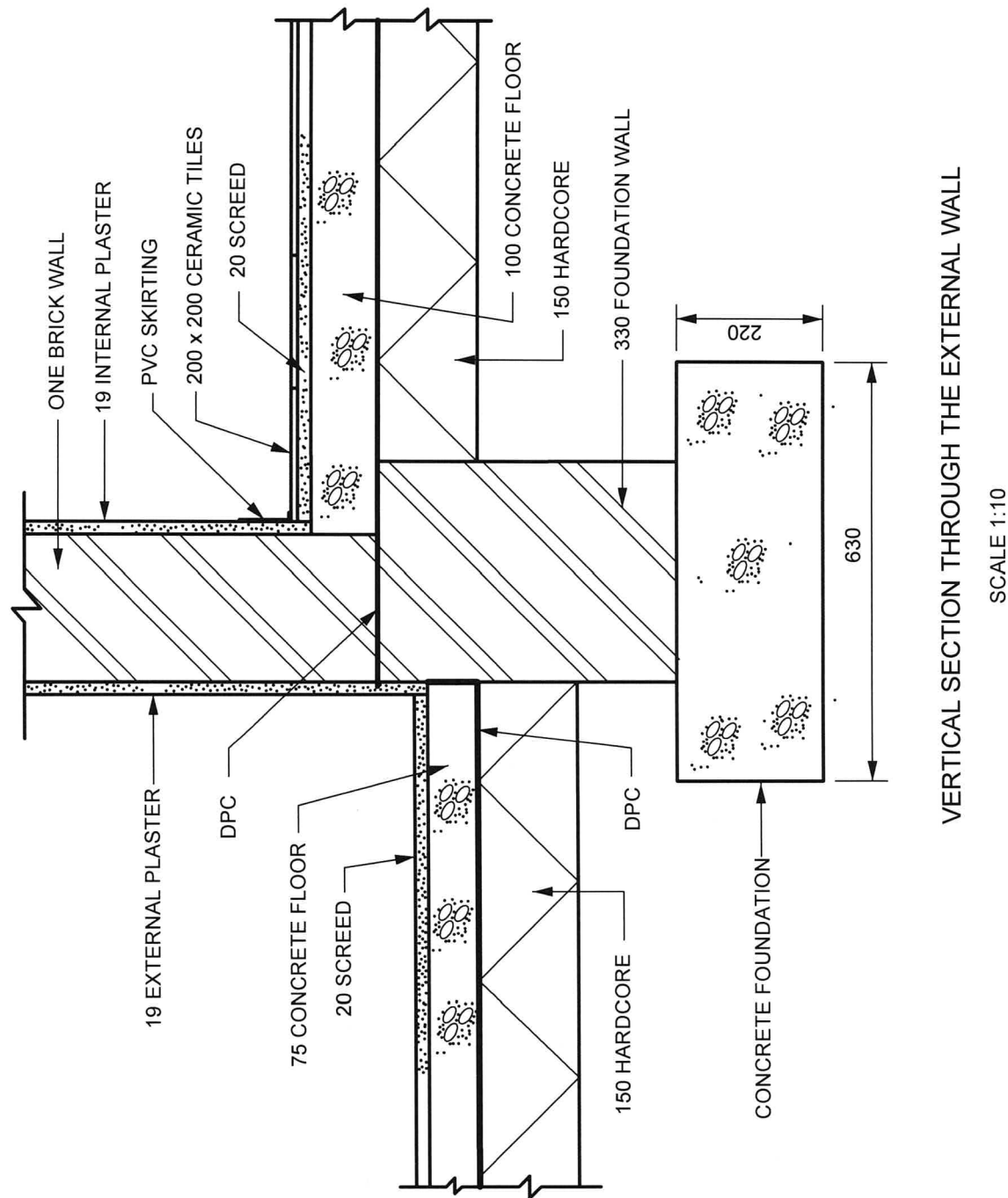

RUBRIC FOR DRAWING QUESTION 2: FOUNDATION AND FLOORS			
PART OF THE DRAWING	MARKING CRITERIA	POSSIBLE MARK	REMARKS
Concrete foundation, foundation wall, external wall, concrete floor, hard core	Correct position	7	Concrete floor and hard core × 2
	Hatching	7	Concrete floor and hard core × 2
	Labelling	7	Concrete floor and hard core × 2
Screed, plaster, tiles, skirting	Correct position	6	Screed and plaster × 2
	Hatching	6	Screed and plaster × 2
	Labelling	6	Screed and plaster × 2
DPC	Correct position	2	DPC × 2
	Labelling	2	DPC × 2
	Dimensions	2	
	Subtotal	45	
	Divide by	3	
	Overall correctness	15	
	Line work	5	
	Accuracy	4	
Balanced layout and neatness		2	
	TOTAL	26	

NOTE: NO marks should be allocated for any part of the drawing in the incorrect position but marks should be allocated for hatching of that component.

SUMMARY QUESTION 2

Marking criteria	Possible mark	Marker	Internal moderator	External moderator
Correct position	15			
Hatching	15			
Labelling	13			
Dimensions	2			
Subtotal	45			
Divide by	3			
Overall correctness	15			
Line work	5			
Accuracy	4			
Balanced layout and neatness	2			
TOTAL	26			

QUESTION 3: ARCHES

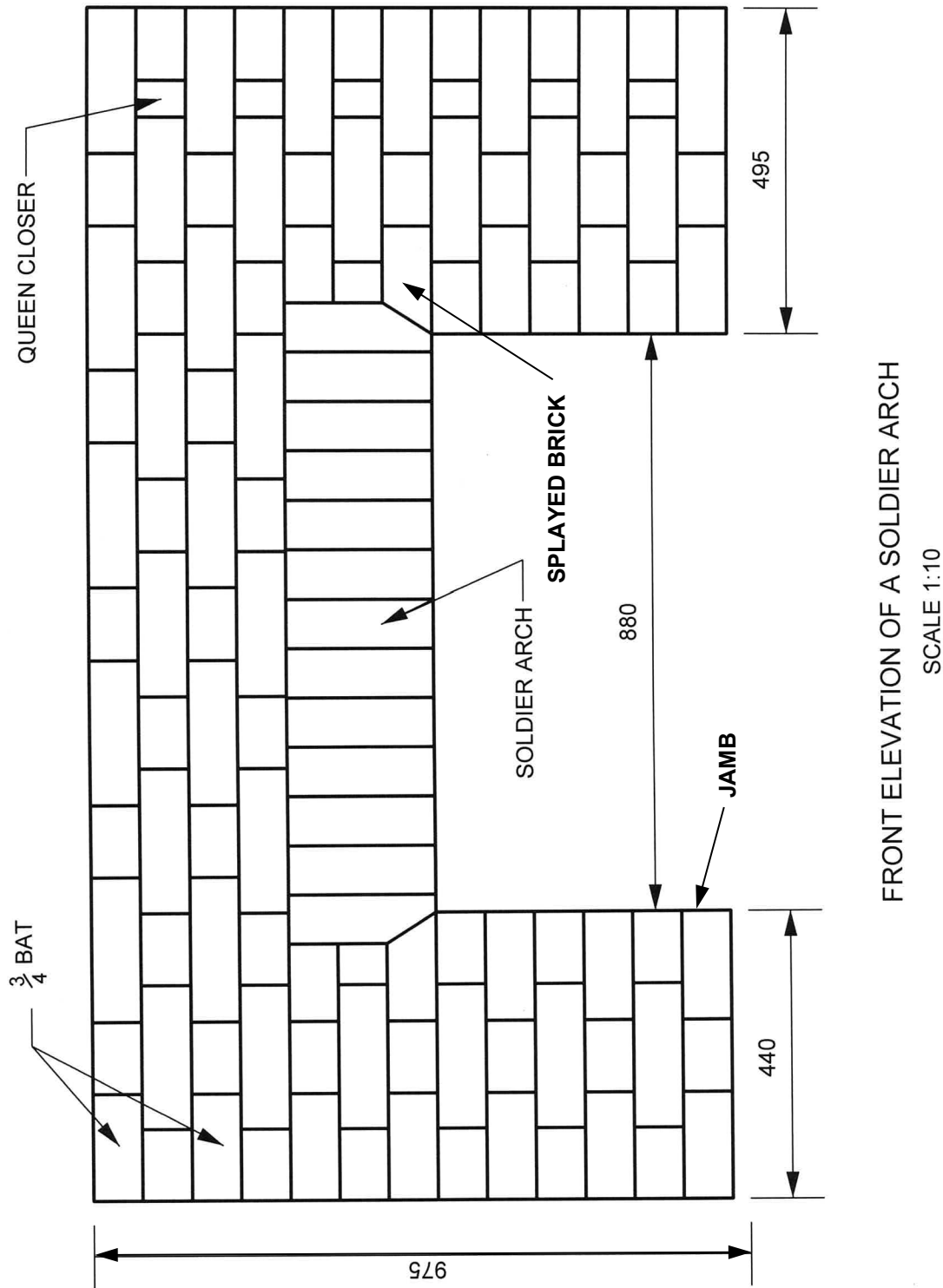

RUBRIC FOR DRAWING QUESTION 3: ARCHES			
PART OF THE DRAWING	MARKING CRITERIA	POSSIBLE MARK	REMARKS
Arch brickwork	Correct arch	3	
	Soldier	1	
	Splayed brick	1	
Surrounding brickwork	Correct bond	2	
	Stopped end	2	
	Labelling	5	$\frac{3}{4}$ Bats, Queen closer, Soldier arch, Splayed brick & Jamb
	Dimensions	4	
	Subtotal	18	
	Divide by	2,25	
	Overall correctness	8	
	Line work	3	
	Accuracy	3	
Balanced layout and neatness		1	
	TOTAL	15	

NOTE: NO marks should be allocated for any part of the drawing in the incorrect position but marks should be allocated for hatching of that component.

SUMMARY QUESTION 3

Marking criteria	Possible mark	Marker	Internal moderator	External moderator
Correct arch	3			
Arch height	1			
Bricks shape	1			
Correct bond	2			
Stopped end	2			
Labelling	5			
Dimensions	4			
Subtotal	18			
Divide by	2,25			
Overall correctness	8			
Line work	3			
Accuracy	3			
Balanced layout and neatness	1			
TOTAL	15			

QUESTION 4: JOINERY

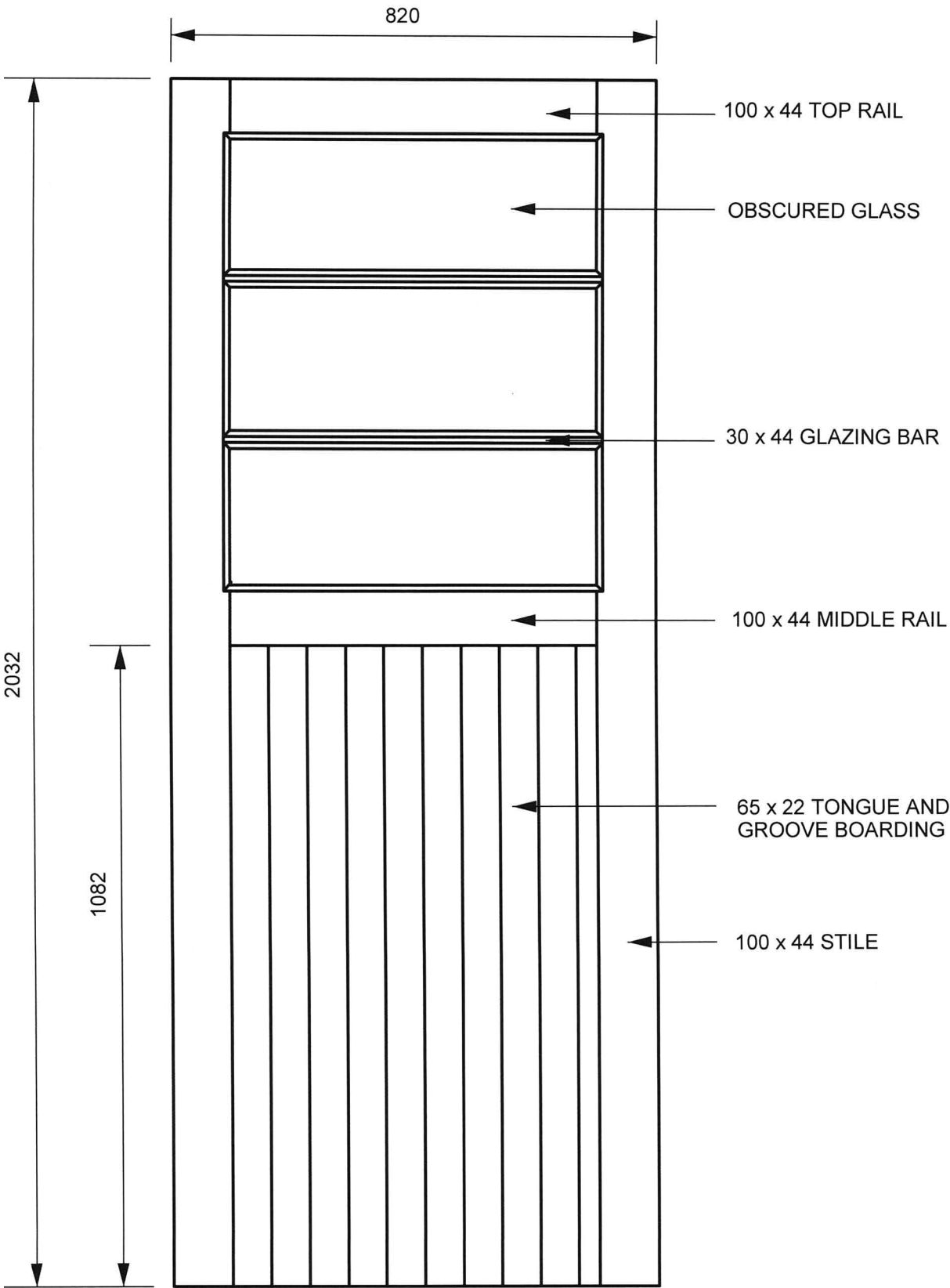

FRONT ELEVATION OF A HALF-GLASS DOOR
SCALE 1:10

RUBRIC FOR DRAWING QUESTION 4: JOINERY			
PART OF THE DRAWING	MARKING CRITERIA	POSSIBLE MARK	REMARKS
Top rail	Correct position	1	
	Labelling	1	
Middle rail	Correct position	1	
	Labelling	1	
Stile	Correct position	2	
	Labelling	1	
Glazing bar	Correct position	1	
	Labelling	1	
Obscured glass	Correct position	3	
	Labelling	1	
Tongue and groove boarding	Correct position	1	
	Labelling	1	
	Dimensions	3	
	Subtotal	18	
	Divide by	2,25	
	Overall correctness	8	
	Line work	3	
	Accuracy	3	
Balanced layout and neatness		1	
	TOTAL	15	

NOTE: NO marks should be allocated for any part of the drawing in the incorrect position but marks should be allocated for hatching of that component.

SUMMARY QUESTION 4

Marking criteria	Possible mark	Marker	Internal moderator	External moderator
Correct position	9			
Labelling	6			
Dimensions	3			
Subtotal	18			
Divide by	2,25			
Overall correctness	8			
Line work	3			
Accuracy	3			
Balanced layout and neatness	1			
TOTAL	15			

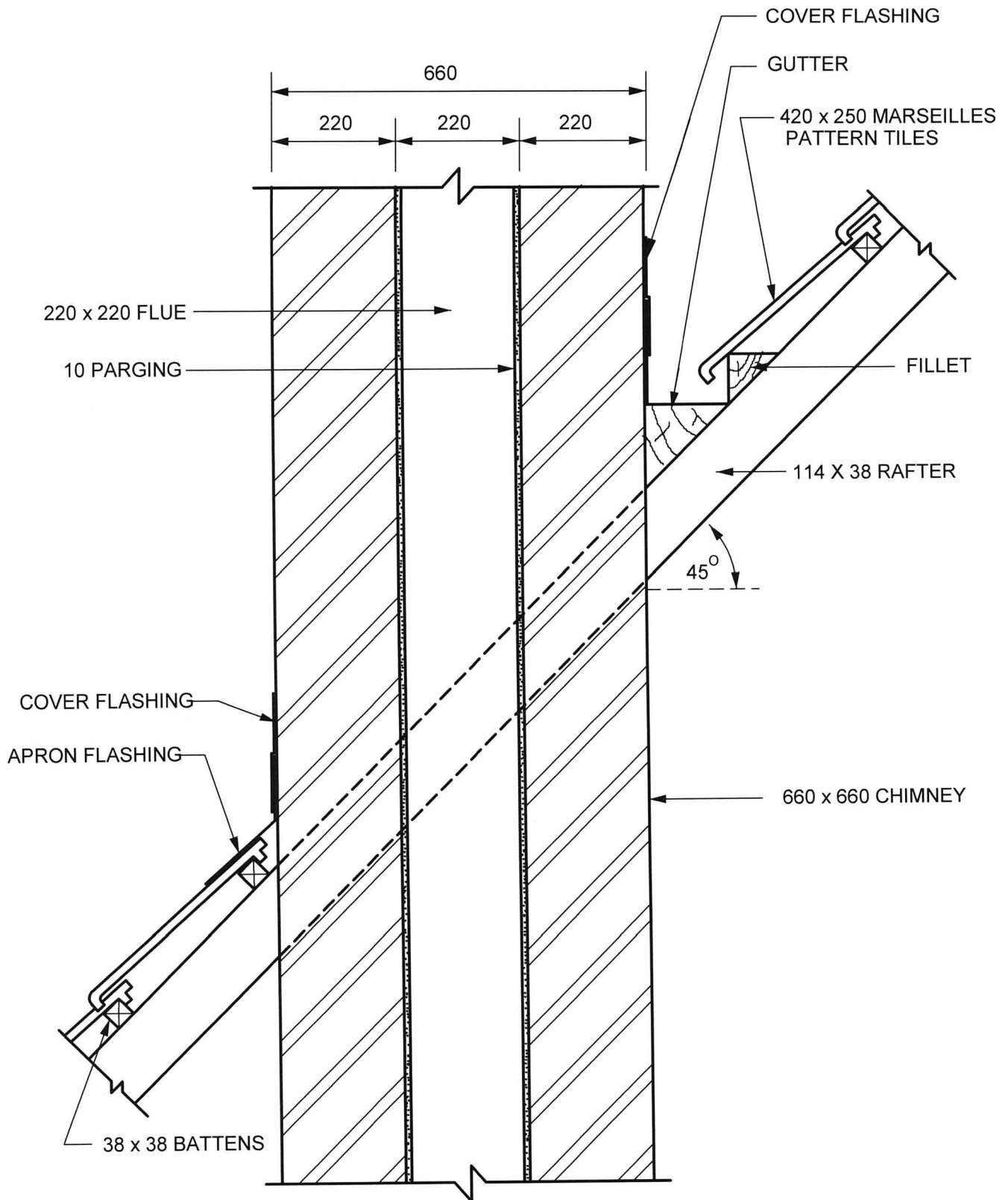
QUESTION 5: ROOFS, CEILINGS AND PLUMBING

VERTICAL SECTION THROUGH A CHIMNEY
SCALE 1:10

RUBRIC FOR DRAWING QUESTION 5: ROOFS, CEILINGS AND PLUMBING			
PART OF THE DRAWING	MARKING CRITERIA	POSSIBLE MARK	REMARKS
Chimney, flue, parging	Correct position	3	
	Hatching	2	
	Labelling	3	
Rafter, battens, fillet	Correct position	3	
	Hatching	2	
	Labelling	3	
Marseilles-pattern tiles, gutter, apron flashing, cover flashing	Correct position	5	Cover flashing × 2
	Labelling	5	
	Dimensions	4	
	Subtotal	30	
	Divide by	3	
	Overall correctness	10	
	Line work	5	
	Accuracy	3	
Balanced layout and neatness		1	
	TOTAL	19	

NOTE: NO marks should be allocated for any part of the drawing in the incorrect position but marks should be allocated for hatching of that component.

SUMMARY QUESTION 5

Marking criteria	Possible mark	Marker	Internal moderator	External moderator
Correct position	11			
Hatching	4			
Labelling	11			
Dimensions	4			
Subtotal	30			
Divide by	3			
Overall correctness	10			
Line work	5			
Accuracy	3			
Balanced layout and neatness	1			
TOTAL	19			

QUESTION 6: MASONRY

- 6.1 Rebated joint with joggle
- 6.2 V-joggle joint
- 6.3 Mortice and tenon joggle joint
- 6.4 Tabling joint using slate joggle
- 6.5 Butt joint with slate joggle

(5 × 2) **[10]****TOTAL: 100**